



**OUTLINE**

**TONER** 

[www.tonerplus.com.ua](http://www.tonerplus.com.ua)

Blank page

# OUTLINE OF SYSTEM

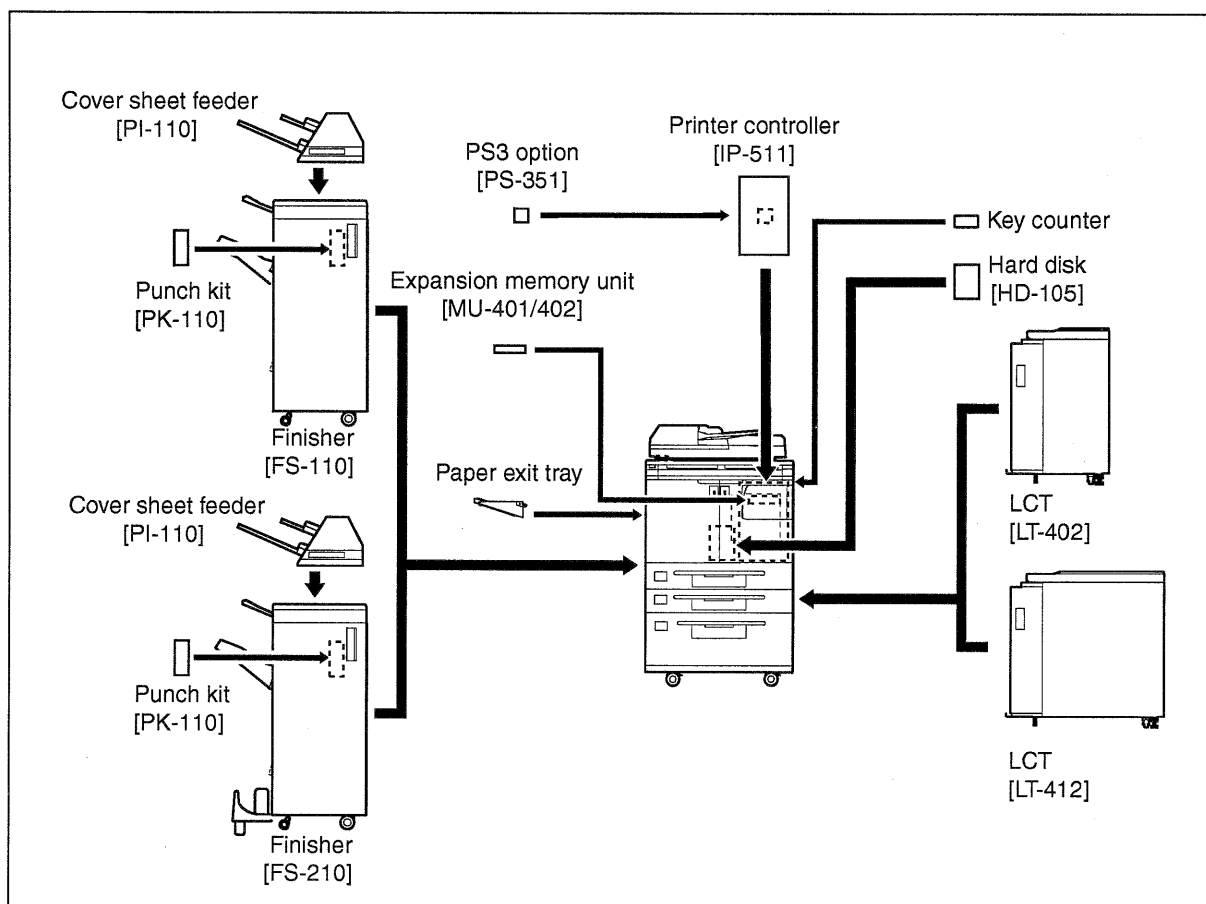

# 7165 PRODUCT SPECIFICATIONS

## [1] Type

### Installation type:

Console type (floor-mounted)

### Copying method:

Indirect electrostatic method

### Document tray type:

Fixed

### Photosensitive material:

OPC

### Sensitizing method:

Laser writing

### Paper feed trays:

Three stacked trays (two for 500 sheets of 80 g/m<sup>2</sup> or 20lbs paper, 1500 sheets of 80 g/m<sup>2</sup> or 20lbs paper)

By-pass tray for various paper sizes (100 sheets of 80 g/m<sup>2</sup> or 20lbs paper)

LT-402 (4000 sheets of 80 g/m<sup>2</sup> or 20lbs paper)\*1,

LT-412 (4000 sheets of 80 g/m<sup>2</sup> or 20lbs paper)\*1

\*1: Optional

## [2] Functions

### Applicable document types:

Sheets, book, solid object

### Document size:

A3/11x17 max.

### Copy paper size:

- Metric area  
A3 to A5, 11x17 to 8.5x11, F4
- Inch area  
11x17 to 8.5x5.5, A3 to B5R, F4  
Wide paper (314 mm x 459 mm max.)

### Magnifications

#### Fixed magnifications:

- Metric area  
x1.00, x2.00, x1.41, x1.22, x1.15, x0.86, 0.82, x0.71, x0.50
- Inch area  
x1.00, x2.00, x1.55, x1.29, x1.21, x0.93, 0.77, x0.65, x0.50

#### Special ratio magnifications:

3 modes

#### Zoom magnifications:

x0.25 to x4.00 (in 1% steps)

#### Vertical magnifications:

x0.25 to x4.00 (in 1% steps)

#### Horizontal magnifications:

x0.25 to x4.00 (in 1% steps)

### Warm-up time:

6 minutes max. (20 °C, rated voltage)

### First copy out time (FCOT)

Mode	A4/8.5x11
Manual	3.1 seconds or shorter

\*Straight paper ejection, platen mode, life size, non AE or AES, without finisher, paper feed from tray 1

### Continuous copy speed (life size, copies/min)

Size	cpm
A4/8.5x11	65

### Continuous copy count:

1 to 9999

### Copy density selection:

AE or AES, manual (9 steps)  
Arbitrary density (2 modes)

### E-RDH memory capacity:

Standard 64 MB  
Maximum 192 MB

## [3] Applicable Copy Paper

### Plain paper:

High-quality paper of 60 g/m<sup>2</sup> or 17lbs to 90 g/m<sup>2</sup> or 24lbs

### Special paper (by-pass feed only):

OHP film  
Blueprint master paper  
(both by-pass tray and stacked trays):  
Tabs  
Plain paper of 50 g/m<sup>2</sup> or 13lbs to 59 g/m<sup>2</sup> or 16lbs  
Plain paper of 91 g/m<sup>2</sup> or 24lbs to 200 g/m<sup>2</sup> or 45lbs

## [4] Options

LCT: LT-402, LT-412

### Key counter

### Expansion memory unit:

MU-401 (64 MB)  
MU-402 (128 MB)

### Paper exit tray

Hard disk: HD-105

Finisher: FS-110, FS-210

Cover sheet feeder: PI-110

Puncher: PK-110

Printer controller: IP-511

Postscript 3: PS-351

**[5] Particulars of Machine****Power supply:**

230 VAC -14% to 10.6% 50Hz/60Hz

120 VAC  $\pm 10\%$  60 Hz**Power consumption:**

230 V Machine : 2300 W max. (full option)

120 V Machine : 1920 W max. (full option)

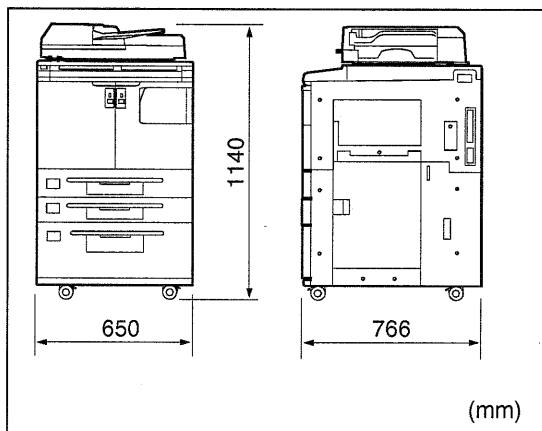
**Weight:** Approx. 203 kg**External dimensions:****[6] Maintenance and Life****Periodic maintenance:** Every 250,000 copies**Machine life:** 5,000,000 copies or 5 years**[7] Consumables****Developer:** Exclusively for Konica 7165**Toner:** Exclusively for Konica 7165**Drum:** Exclusively for Konica 7165 ( $\phi 80$ )**[8] Environmental Conditions****Temperature:** 10°C to 30°C (50°F to 86°F)**Humidity:** 10% to 80% RH

**Note:** The information herein may be subject to change for improvement without notice.

# CENTRAL CROSS-SECTIONAL VIEW

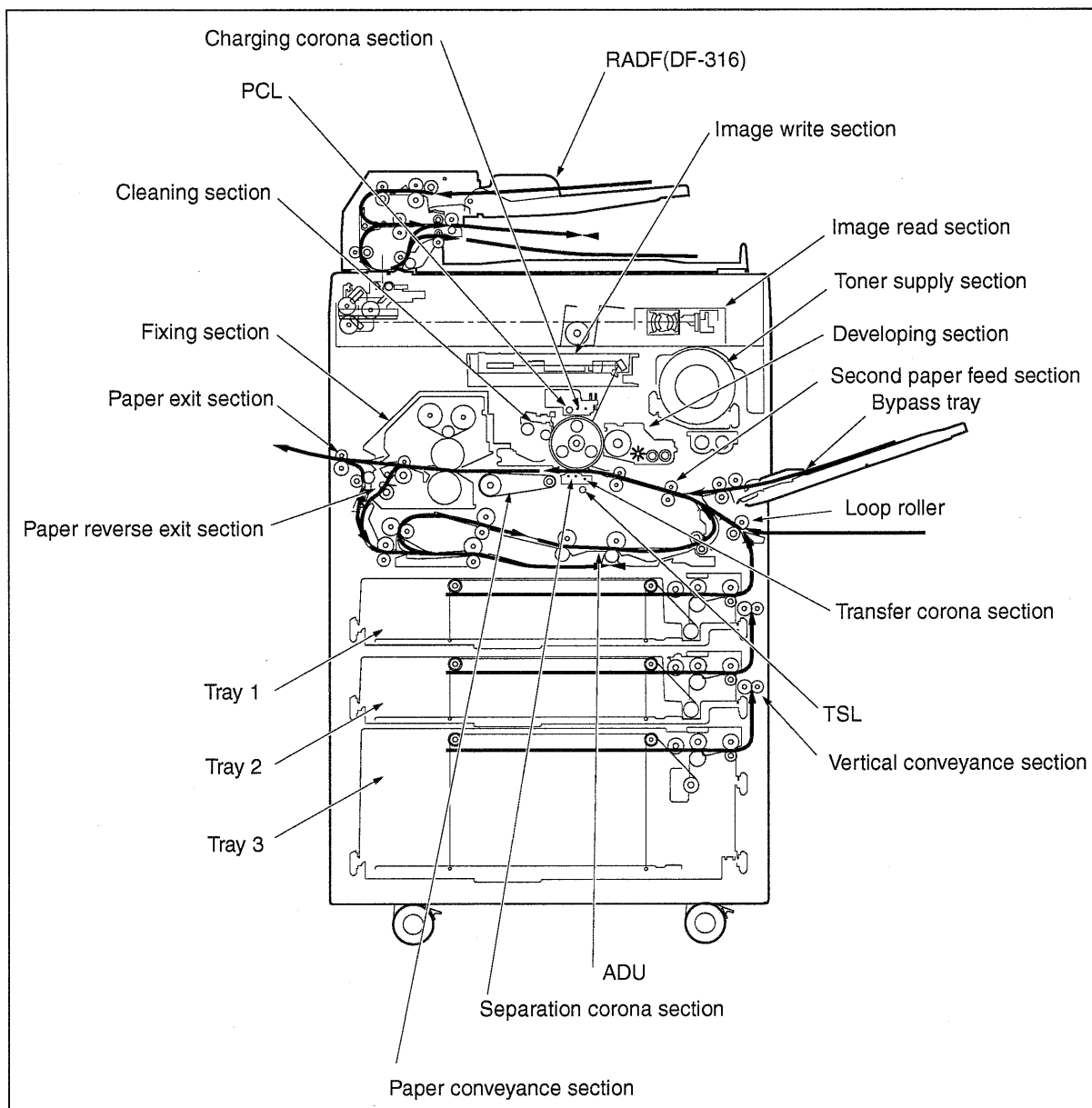

# DRIVE SYSTEM DIAGRAM

## [1] Fixing/Web Drive Section

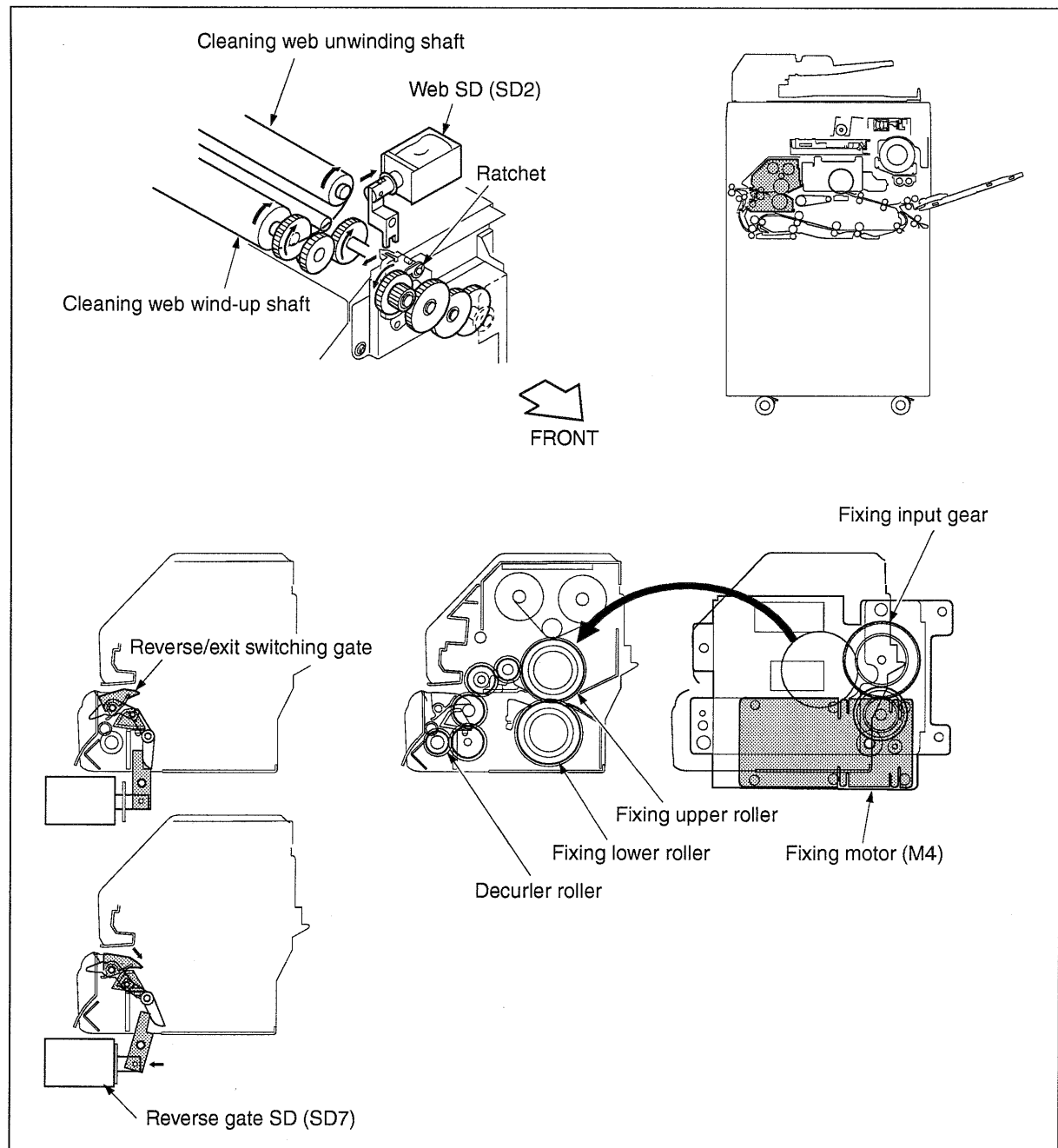

## [2] Drum Drive Section

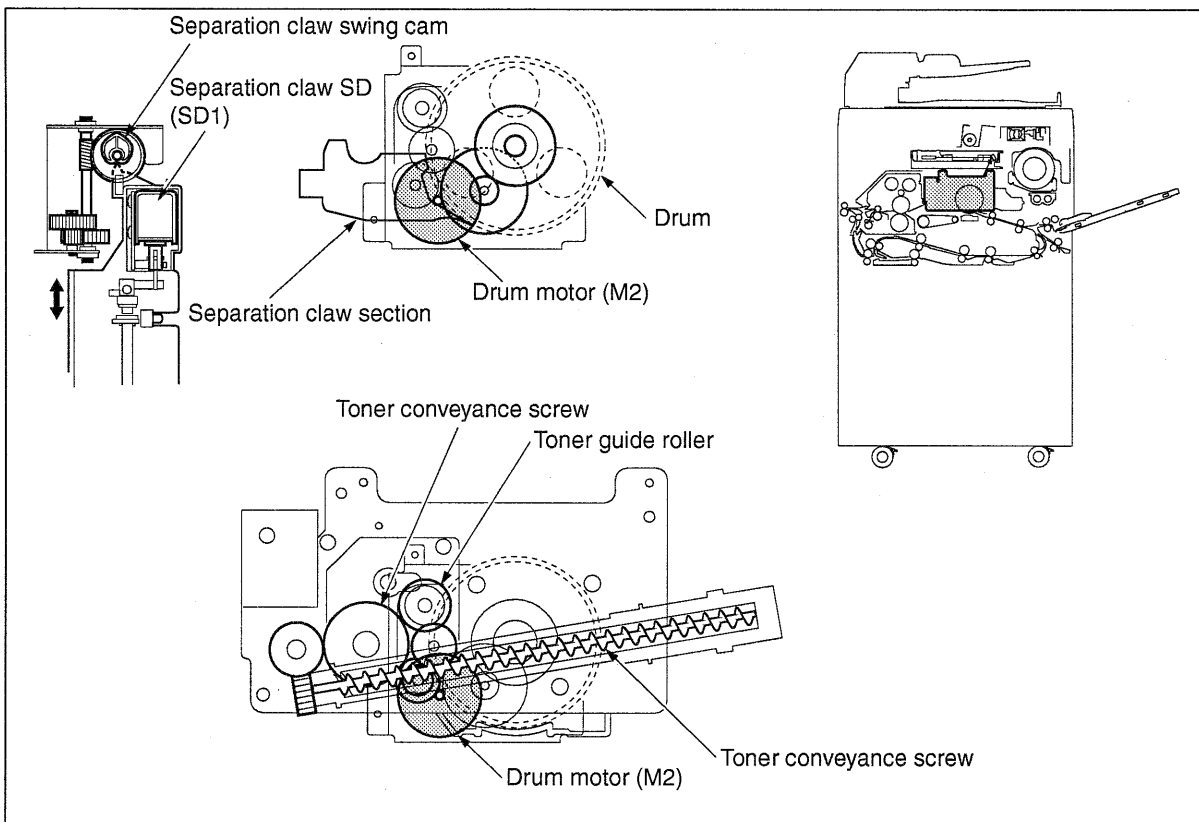

## [3] Developing Drive Section

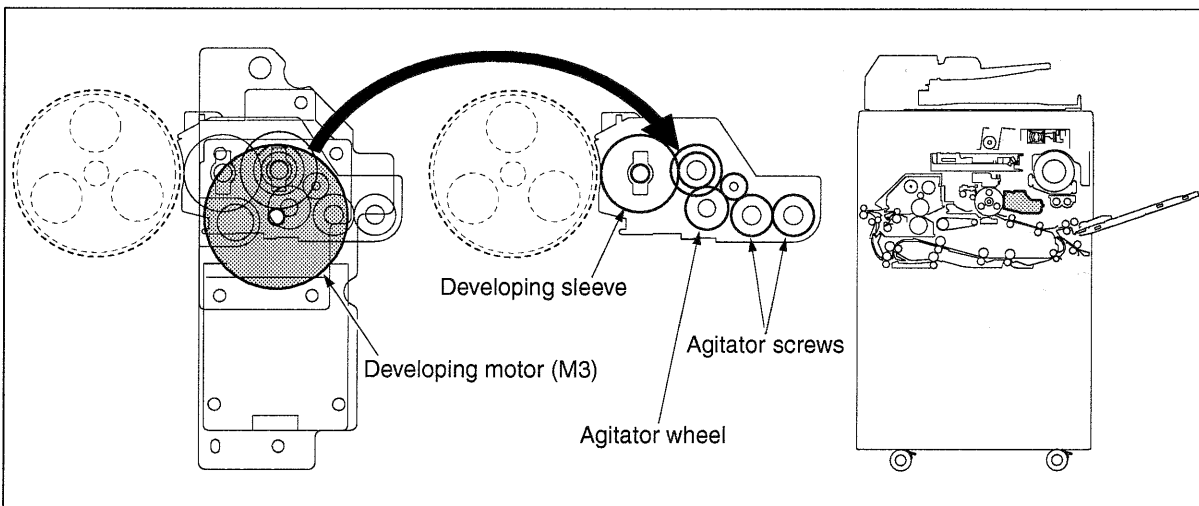

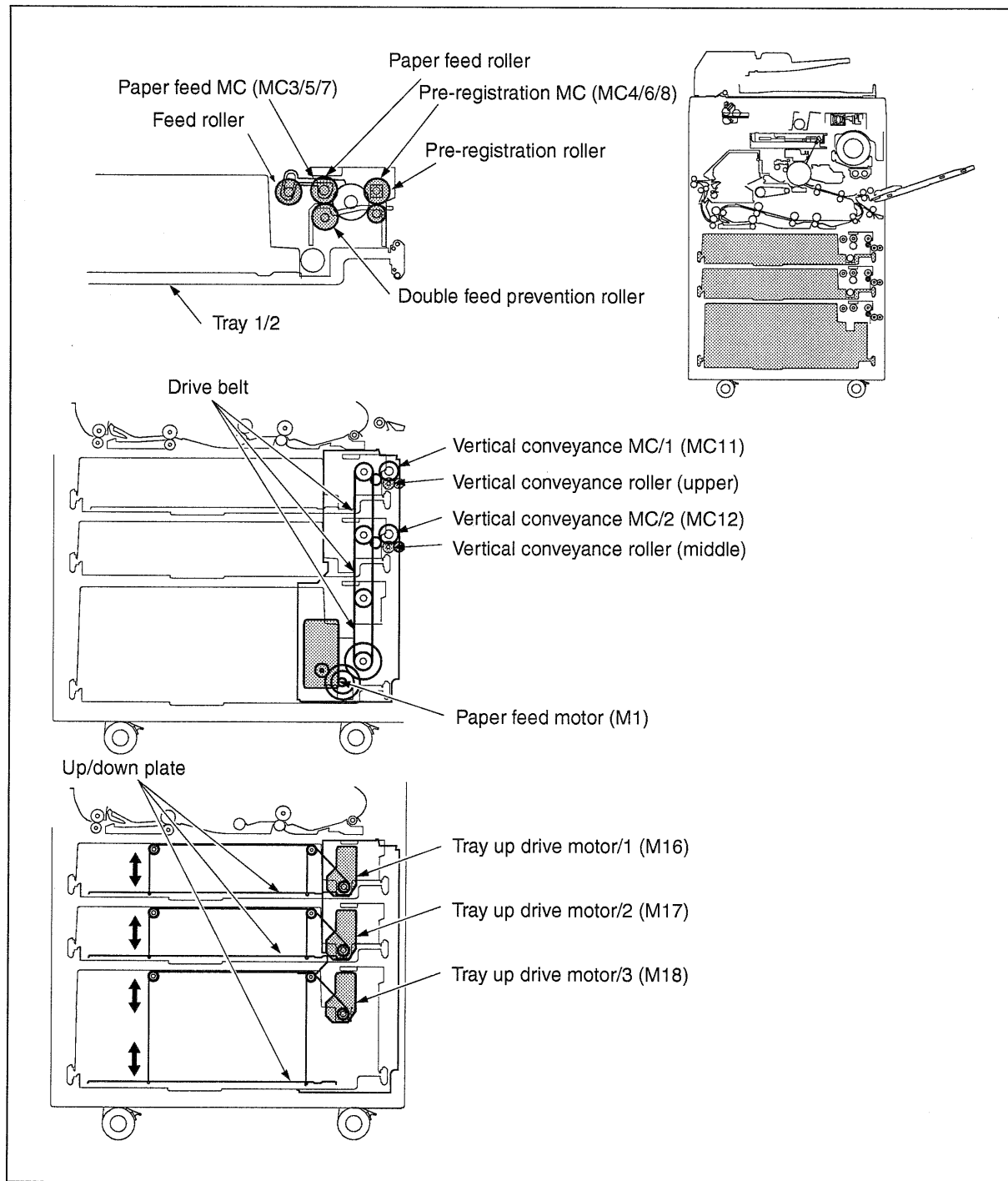

**[4] Paper Feed/Vertical Conveyance/Tray Up Drive Sections**

[5] By-pass Paper Feed /ADU Pre-registration Drive Section

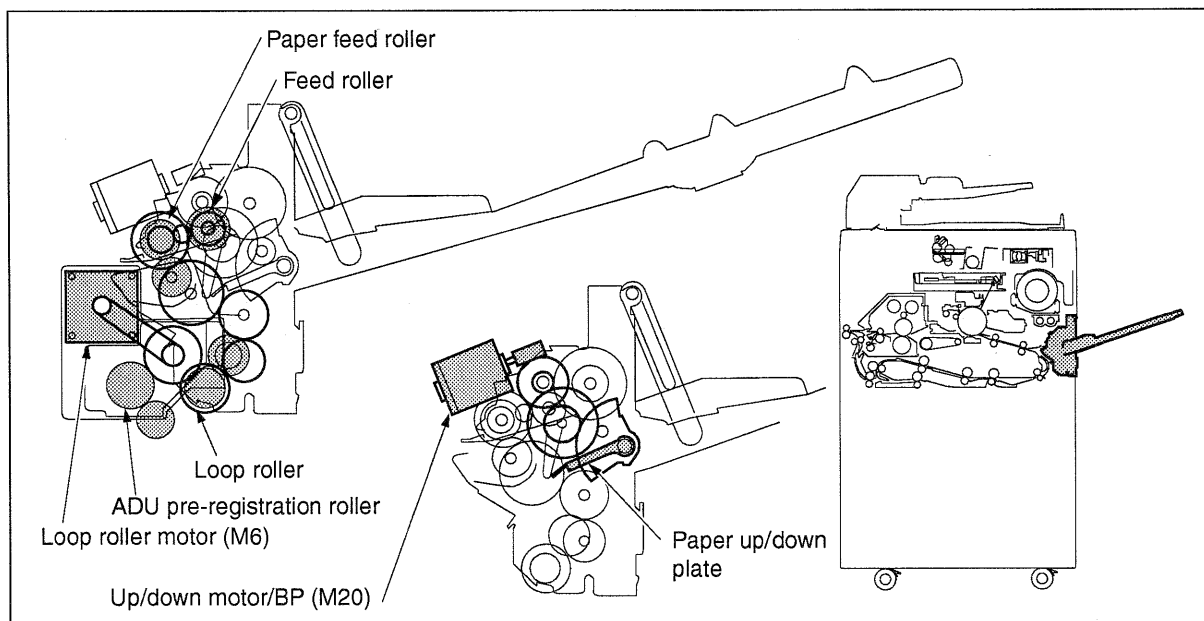

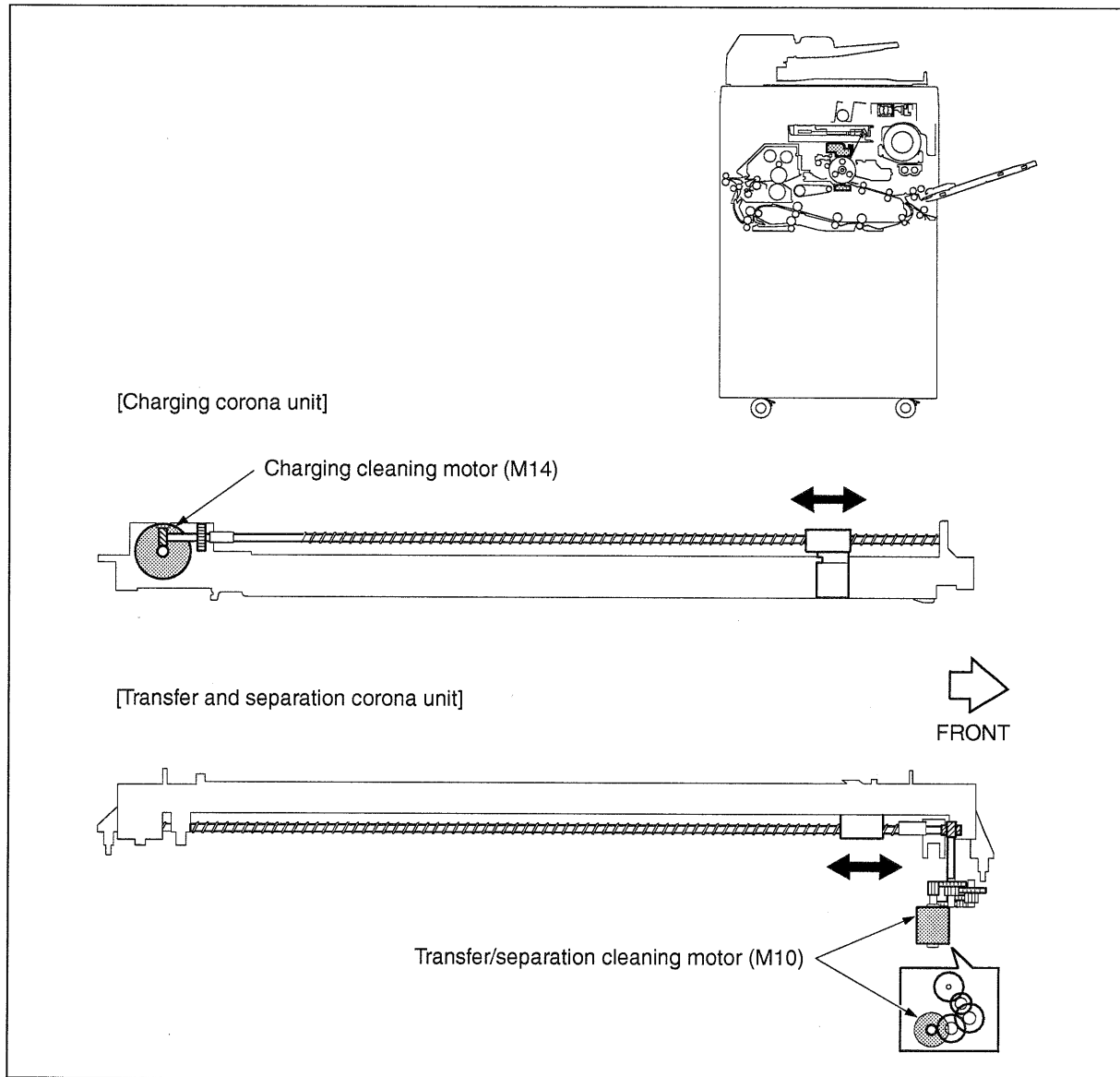
**[6] Charging and Transfer/Separation Wire Cleaning Drive Section**

[7] ADU Conveyance Drive Section

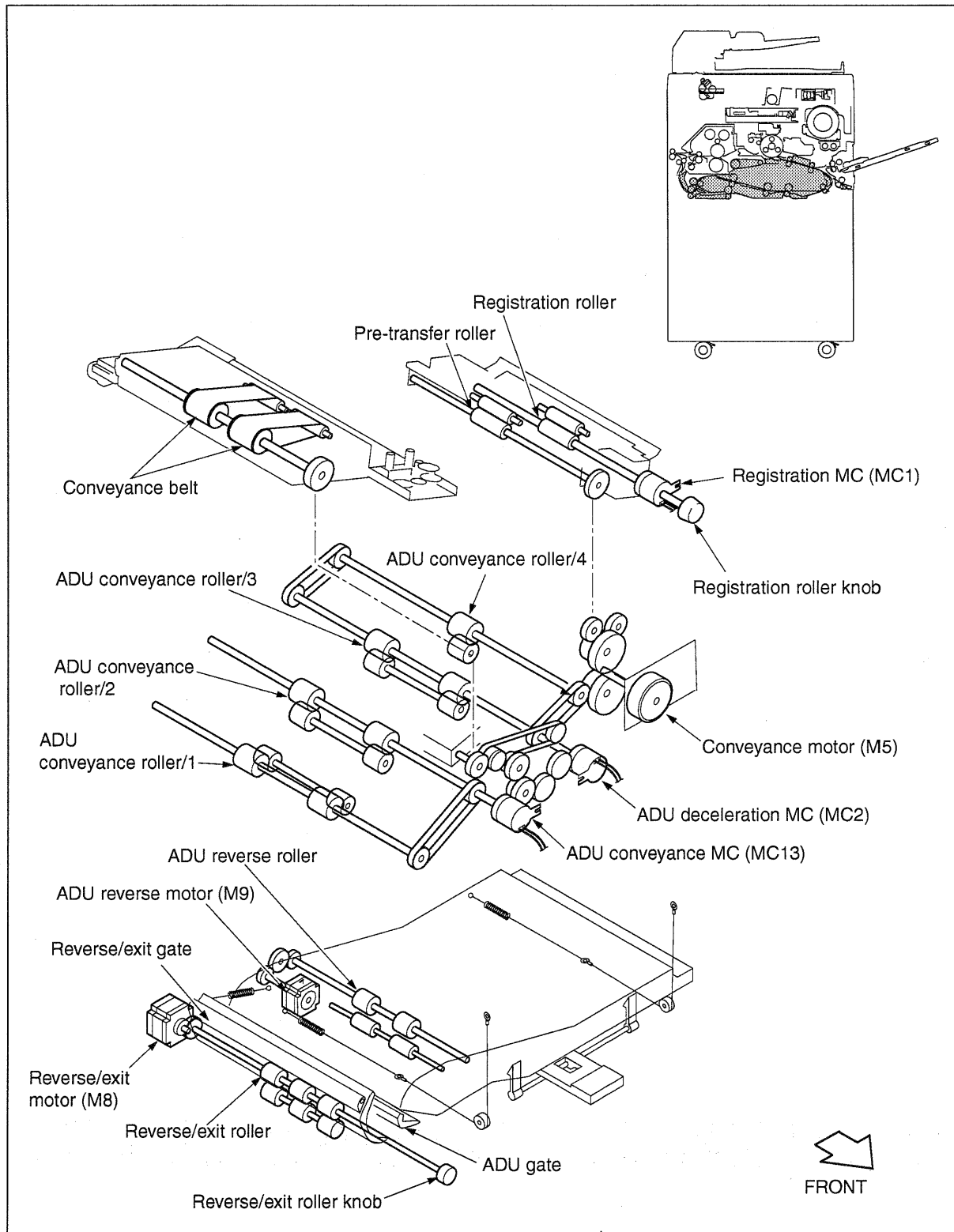

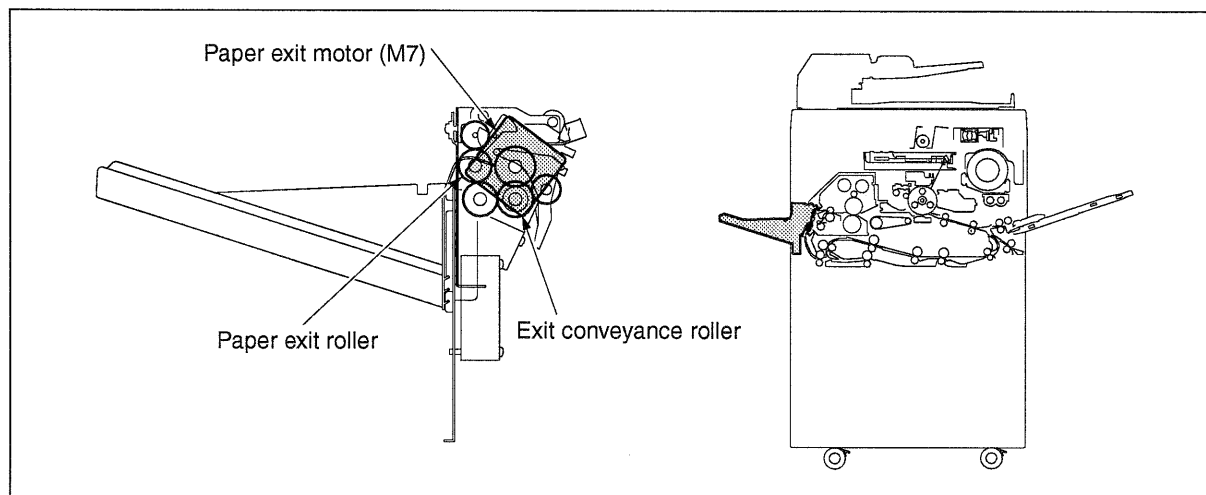
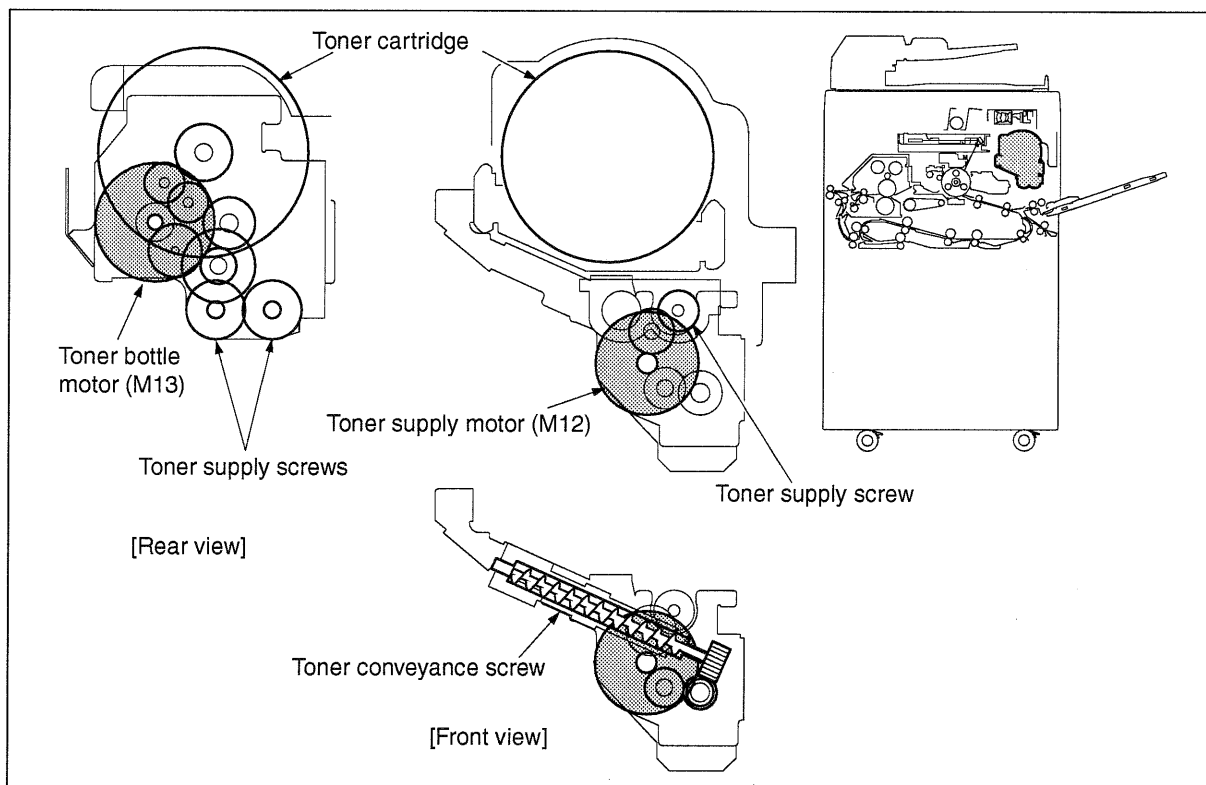
**[8] Paper Exit Drive Section****[9] Toner Supply Drive Section**

[10] Optics Drive Section

